

With or without armrest version
With or without backrest version

Leg supports technology:

Cast iron.

Finish: Graphite polyester powder paint.

Seat technology:

Eucalyptus grandis laminated wood with natural or brown sealer, or painted white.

Installation:

Free standing or fixed to ground with chemical anchor bolts.

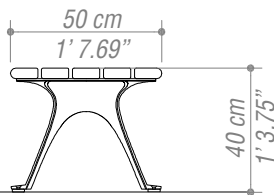

Without backrest

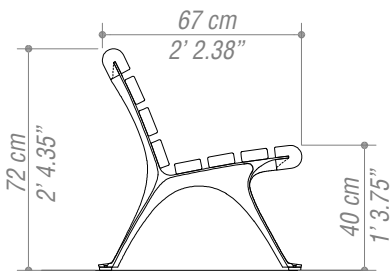

With backrest

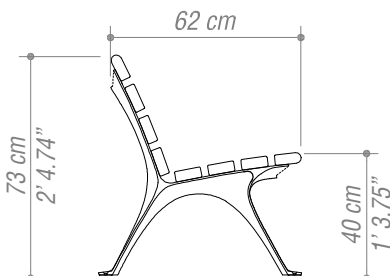

With backrest - light version

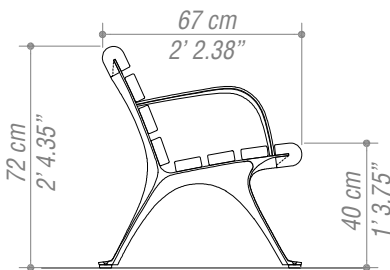

With backrest and armrest

Available lengths: 80, 120, 170, 210, 240, 300, 400, 600 cm

With backrest

80 cm / 31" 2/5 version

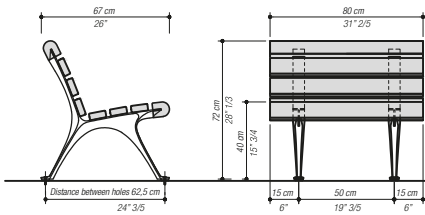

120 cm / 51" version

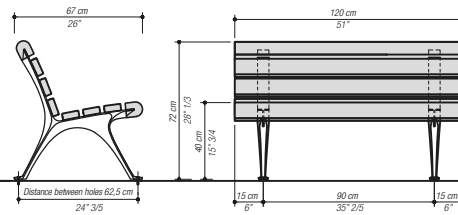

170 cm / 67" version

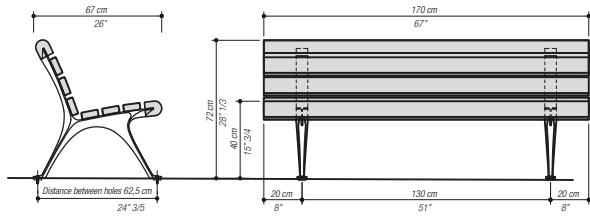

210 cm / 82" 3/5 version

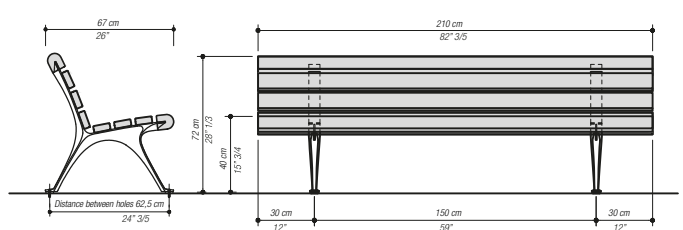

240 cm / 94" 1/2 version

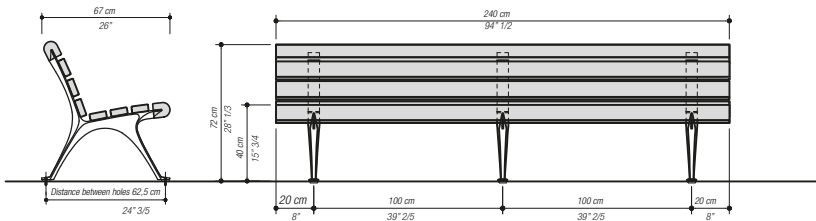

300 cm / 118" version

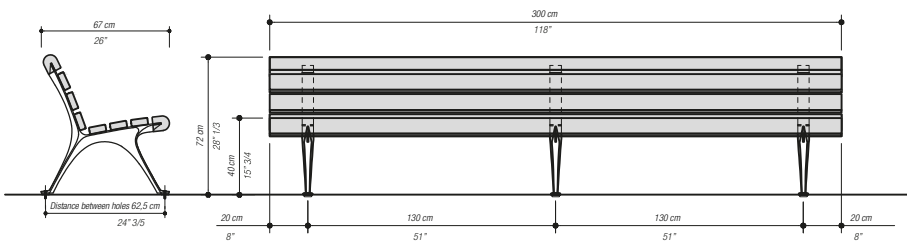

600 cm / 236" version

